

# VPD3-1 V-CUT DEPANELIZER

## V 槽分板機(滑軌型)

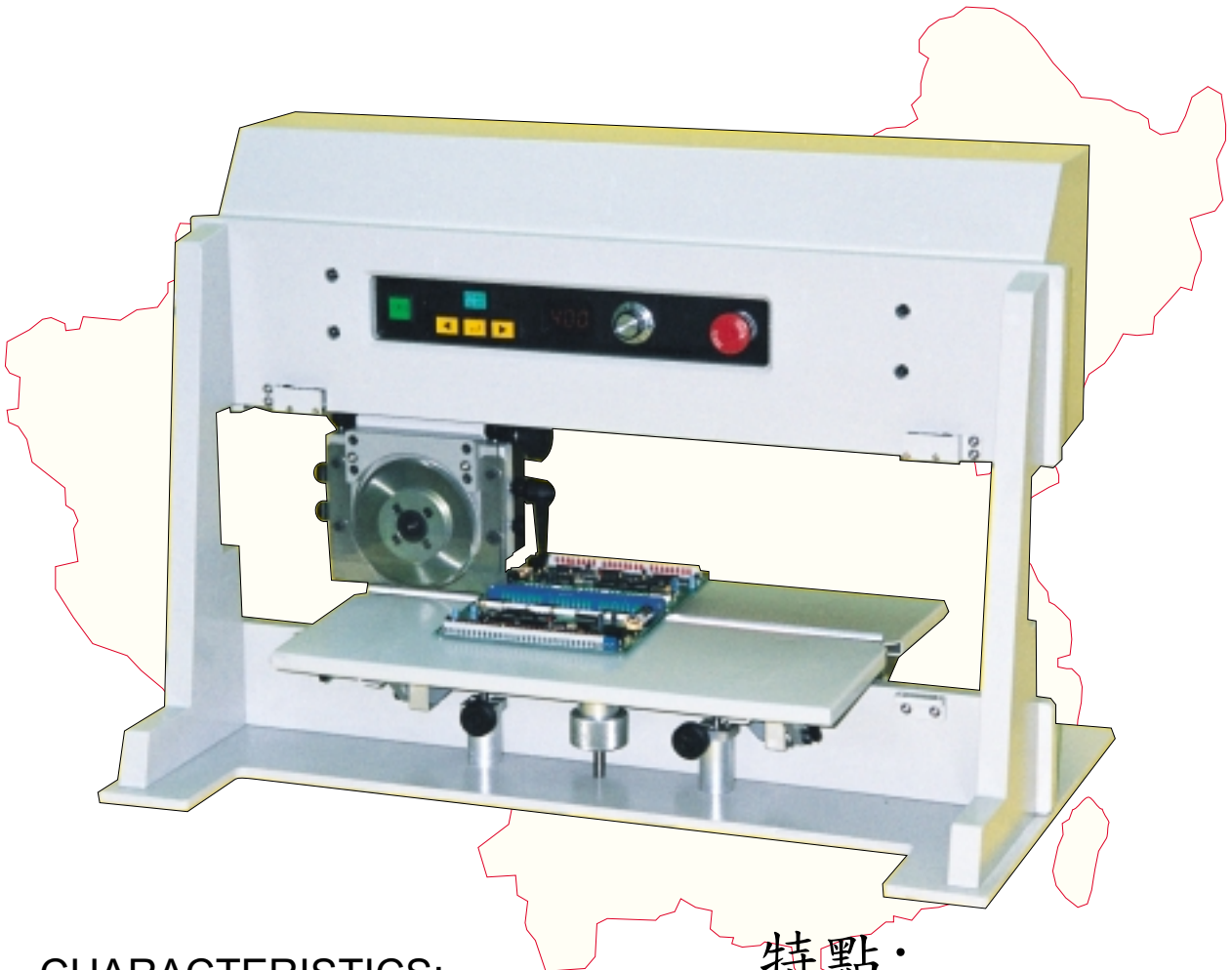

### CHARACTERISTICS:

- \* Separation of the PCB assembly without stressing components or lifting circuit traces.
- \* The PCB V-groove is laid onto the edge of the lower linear blade. When the foot switch is pressed, the upper circular blade will move across the groove and separates into individual units.
- \* Separation speeds can be adjusted with a rotary knob and is shown on the scale. Separation lengths can be programmed and displayed clearly by LED.
- \* The V-groove can be interrupted by any number of cut-outs. Also boards with projecting components can also be cut precisely.
- \* The clearance between the circular and linear blades can be adjusted precisely for different groove depths and compensates for blade wear out.

### 特點：

- \* 將分板時所產生的內應力減至最低而避免錫裂現象。
- \* 基板V槽安放於下直切刀刀尖上,按動腳踏後,上圓切刀會滑過V槽,將基板分開。
- \* 分切速度透過旋鈕控制並有刻度顯示,分板行程可自由設定並由LED顯示。
- \* V槽上可容許出現缺口而不影響分切動作,同時亦解決零件跨越V槽之情況。
- \* 因應V槽深淺及刀具損耗,上圓與下直切刀之間距離可準確調整。

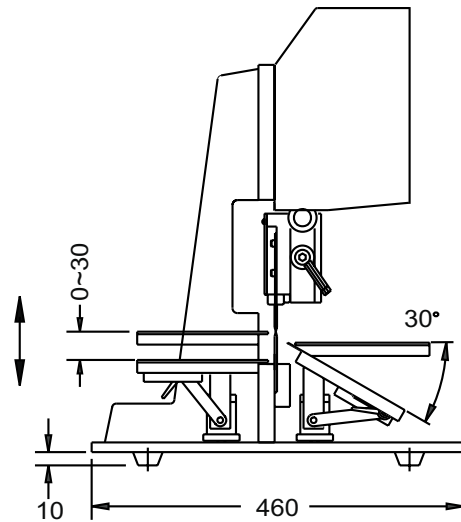
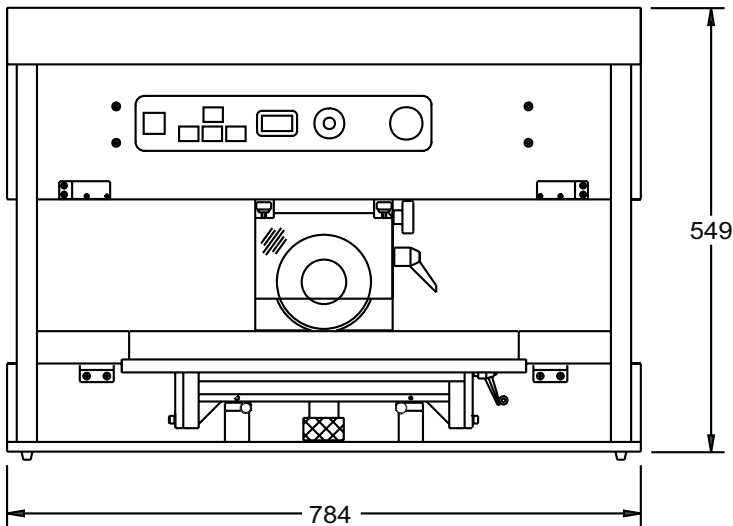

VPD3-1

| Specification    |        | 規格   |           |
|------------------|--------|--|-----------|
|                  |        | A: >0.25mm<br>B: Max. 1.5mm<br>Standard cutter<br>標準切刀<br>C: ≥2mm<br>$\theta$ : ≥30°<br>Blades can be<br>Customer-made<br>切刀之外形可訂造 |           |
| Max. PCB length  | 最大分板長度 | mm   | 460       |
| Separation speed | 分板速度   | mm/sec   | 0 ~ 500   |
| Power supply     | 使用電壓   | VAC  | 110 / 220 |
| Weight           | 機重     | Kg   | 50        |



**SMartop Technology Limited**  
**創盛科技有限公司**

Flat B, 9/F., Wing Yip Ind. Bldg., 21-27 Wing Yip St.,  
 Kwai Chung, N.T., Hong Kong.

香港辦事處: Tel : (852) 2790 4433 / 2790 4438

Fax : (852) 2790 5918

Email : sales@smartop.com.hk

中國辦事處: Tel : 86-769-556 1321 / 86-769-556 5921

Fax : 86-769-556 7183

Email : dg.sales@smartop.com.hk

